

FORM NO 1.

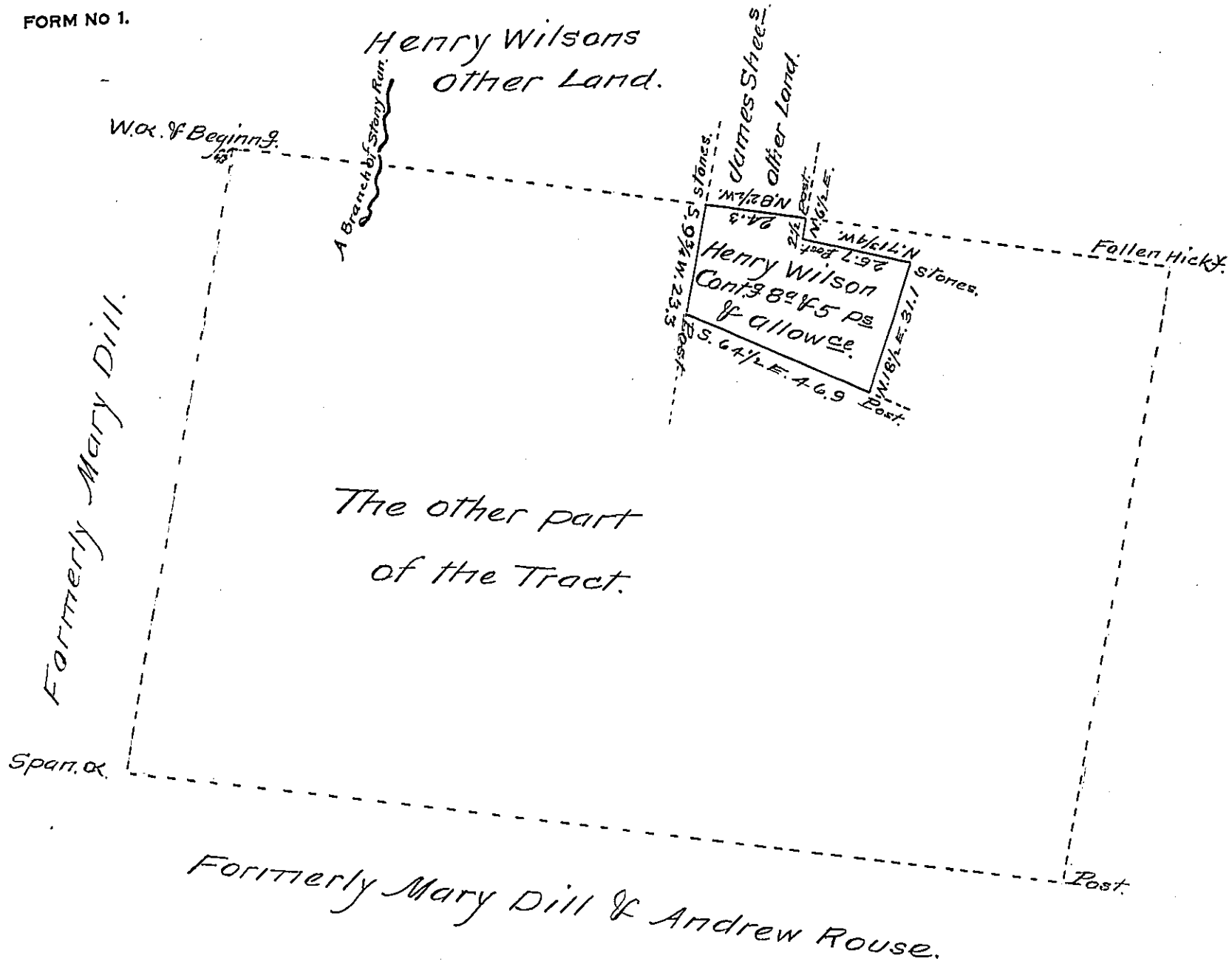

Situate part in Manahan and part in Franklin Township in the County of York (late part of the County of Lancaster) Containing within the black lines as above set forth 80^{1/2} & 5 Ps. and allowance. Being part of a larger Tract of 190^{1/2} & 35 Ps. and all^{ce}. which was originally Surveyed by Thomas Armor late D.S. under George Stevenson late D.S. in pursuance of a warrant for 100^{1/2} granted to Henry Wilson bearing date the 22^d. day of October A. D. 1742. Resurveyed and Divided off from the said larger Tract of Land the 3^d. day of February 1821 at the request of James Shee the present owner.

To Jacob Spangler Esq.
Surveyor General
Harrisburg Pa.

Peter Spangler D.S.

IN TESTIMONY that the above is a copy of the original remaining on file in the Department of Internal Affairs of Pennsylvania, made conformably to an Act of Assembly approved the 16th day of February, 1833, I have hereunto set my Hand and caused the Seal of said Department to be affixed at Harrisburg, this twelfth day of September 1907.

Henry Howell
Secretary of Internal Affairs.